

PARTIAL HVAC PLAN 1ST FLOOR
SCALE: 1/16" = 1'-0"

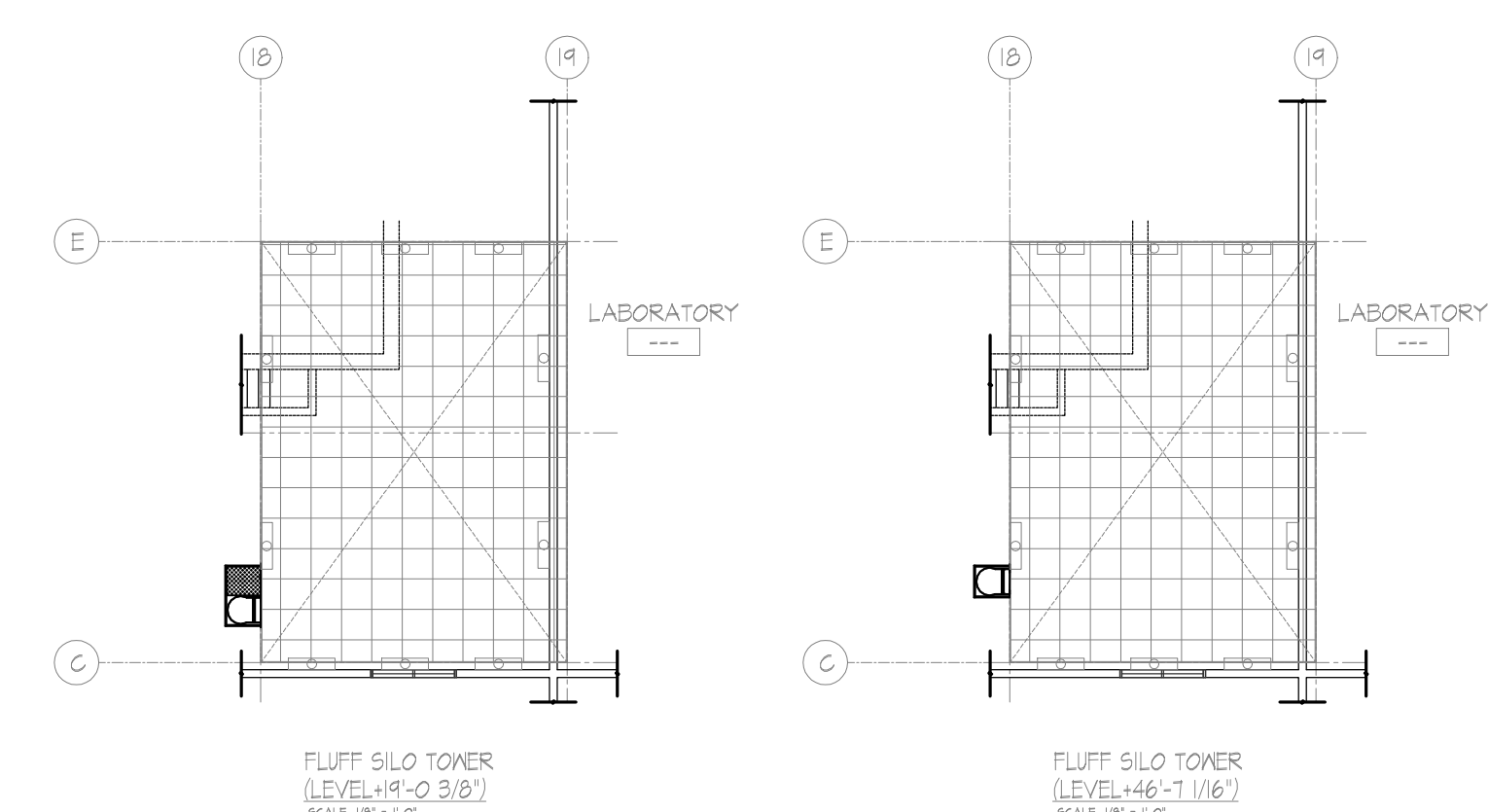
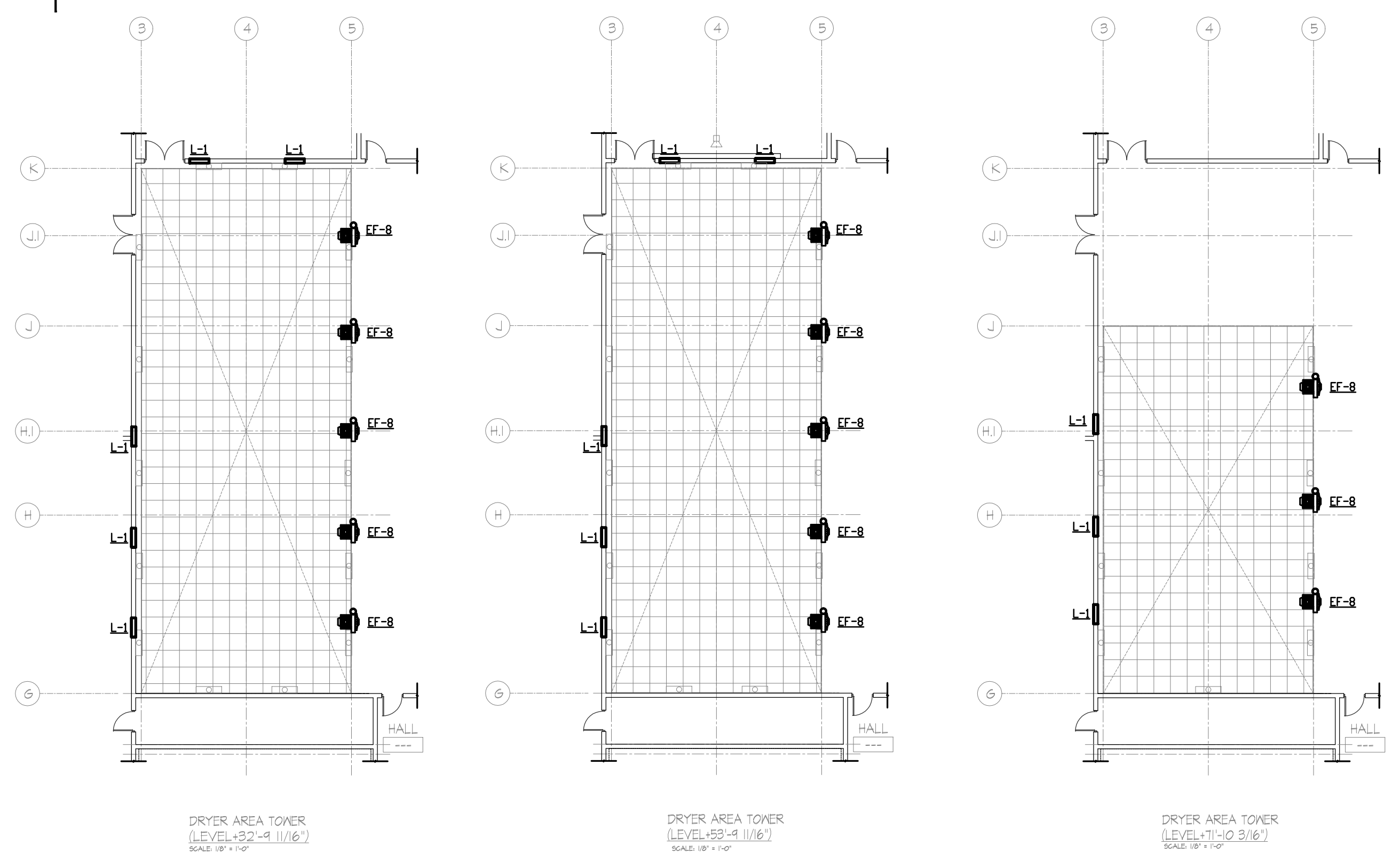

GENERAL NOTES:

- THE FOLLOWING NOTES AND ANY OTHER GENERAL NOTES IN THE DRAWINGS ARE GENERAL IN NATURE AND PERTAIN TO THE ENTIRE PROJECT. WHERE THERE ARE EXCEPTIONS, ADDITIONS OR REVISIONS TO THESE NOTES, SUCH EXCEPTIONS, ADDITIONS OR REVISIONS ARE NOTED ON THE PARTICULAR DRAWING WHERE THEY OCCUR.
- FOR CLARITY, THE PIPING SHOWN ON THE PLANS ARE DIAGRAMMATIC, AND MAY NOT SHOW ALL BENDS, OFFSET, ROUTING, AND FITTINGS NECESSARY FOR THE INSTALLATION OF THE EQUIPMENT AS INTENDED.
- THE MECHANICAL CONTRACTOR SHALL COORDINATE WITH ALL OTHER TRADES IN THE INSTALLATION OF MECHANICAL EQUIPMENT AND ALL ASSOCIATED ACCESSORIES, PRIOR TO INSTALLING EQUIPMENT.
- PROVIDE MECHANICAL SLEEVES FOR ALL PENETRATIONS BELOW GRADE.
- CONCEAL ALL PIPING WHENEVER POSSIBLE UNLESS OTHERWISE NOTED.
- ALL PENETRATIONS IN MECHANICAL ROOMS, CORRIDORS AND STAIRWELLS NEED TO BE FIRE STOPPED AND ANY EXISTING HOLES IN WALLS, FLOORS AND CEILING OR HOLES CREATED BY REMOVAL OF EQUIPMENT, DUCT OR PIPING MUST BE PATCHED TO MATCH EXISTING FIRE RATING, FINISH & COLOR.
- THE CONTRACTOR IS TO VERIFY EXISTING CONDITIONS PRIOR TO BID AND START OF ANY WORK.
- ALL MECHANICAL INSTALLATION SHALL COMPLY WITH FEDERAL, STATE AND LOCAL CODES.
- HVAC SYSTEM TO BE BALANCED TO CFM NOTES ON PLANS.
- ALL ROOF TOP EQUIPMENT TO BE LOCATED A MINIMUM OF 10' FROM EDGE OF ROOF OR HAVE BARRIERS INSTALLED PER KYOSAA STANDARDS.
- INSULATED FLEXIBLE DUCT MAY BE USED TO MAKE CONNECTIONS TO DIFFUSER COLLAR EXTENSION. MAXIMUM LENGTH OF FLEX DUCT IS 5'-0".

SHEET NOTES:

- PROVIDE AIR HANDLER UNIT ON MEZZANINE (SEE 0441 SCHEDULE FOR SPECIFICATIONS).
- PROVIDE CARBON MONOXIDE MONITOR TO ACTIVATE EXHAUST FANS WHEN CO LEVEL REACHES 25 PPM.
- R-3 BOTH SIDES OF WALL, MOUNT AT 80" AFF.
- RELUAT AT 20" AFF.
- NET USED.
- ROUTE DUCTWORK ABOVE CRANE.

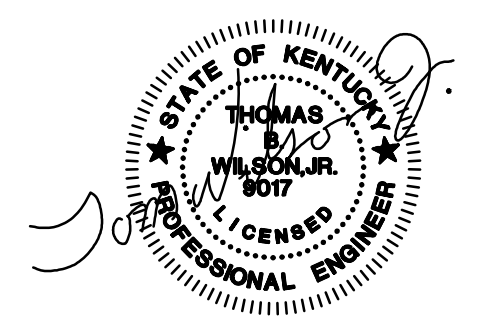

AIA
AMERICAN INSTITUTE OF ARCHITECTS
1735 N. MOUNTAIN VIEW AVENUE
RESTON, VA 20191-4400
PHONE: (703) 790-8800
FACSIMILE: (703) 790-4330

FLEXFILMS, U.S.A., LLC
 1221 NORTH BLACK BRANCH ROAD
 ELIZABETHTOWN, KENTUCKY 42702

PROJECT L-12 BOPET U.S.A.

DATE	REVISION	BY
NOV. 11, 2011	VALUE ENGINEERING RE-DESIGN DOCUMENT	
JAN 28, 2012	REVISIONS ASSOCIATED WITH REVISED FLOOR PLAN	

PROJECT NO. 8529-02
 DESIGNED BY RCD
 DRAWN BY RCD
 CHECKED BY TBW
 REVIEWED BY LMW
 DATE JULY 2011
 SCALE 1/8" NOTED

DESIGN DOCUMENTS: THESE DRAWINGS AND ALL RESPONSIBILITY AND LIABILITY FOR PROBLEMS WHICH MAY BECOME KNOWN TO FOLLOW FROM PLANS, SPECIFICATIONS AND THE DESIGN THEREIN BELONG TO THE ARCHITECT.
 THE ARCHITECT'S DESIGN IS SUBJECT TO THE NECESSARY PERMITS AND REGULATIONS OF THE LOCAL, STATE AND FEDERAL GOVERNMENTS.
 THIS DOCUMENT IS THE PROPERTY OF M.S.E. OF KENTUCKY, INC. AND IS TO BE USED ONLY FOR THE PROJECT AND SITE SPECIFICALLY IDENTIFIED HEREIN.
 NO PART OF THIS DOCUMENT IS TO BE REPRODUCED OR TRANSMITTED IN ANY FORM OR BY ANY MEANS, ELECTRONIC OR MECHANICAL, WITHOUT THE WRITTEN PERMISSION OF M.S.E. OF KENTUCKY, INC.

M.S.E.
 OF KENTUCKY, INC.

Engineers
 Architects
 Planners
 Phone: (859) 223-2684
 624 Wellington Way
 Lexington, KY 40503
 Fax: (859) 223-2607
 www.msese.com

DRAWING NO.

UFL-L12
 M-001B